

Lakeside

LIFE, CURATED.

The Fairway



Stockland



Lakeside

The Fairway, immersed in breath-taking greenery.

As the cool breeze wafts from the lake, across the surrounding green expanses and into your new home in Lakeside, you'll be transported to a sanctuary of serenity. Where the cares of the world are left behind, and the curated lifestyle you deserve is waiting.



Lakeside Golf Club Camden is owned and operated by an unrelated thrid party. Stockland does not give any warranty or make any representation regarding the operations and/or continued use of the land as a golf course.



Legend

The Fairway Lots

Proposed Display Village by Sekisui House^^

5.5m Easement
3.5m Easement
3.0m Easement
1.5m Easement

1.2m Easement
0.9m Easement
Restriction on use of land
Substation Easement

Golf Course Maintenance Shed^

Lakeside Golf Club Camden^

Lakeside Golf Club Camden Club House^

The heart of Lakeside

Surrounded by the current Lakeside Golf Club Camden^, in the very centre of Stockland's boutique new community of Lakeside, The Fairway precinct is the jewel in this sparkling crown. This premium location offers the ideal balance of privacy and connection, with most homes only ever having two neighbouring houses. With stunning views of the golf course and Clubhouse one side, the lake and tree-lined fairway on the other, plots in The Fairway are understandably selling fast.

Release plan supplied for the purpose of providing an impression of Stockland Lakeside and the approximate location of existing and proposed third party infrastructure, facilities, amenities, services and destinations, and is not intended to be used for any other purpose. Indications of location, distance or size are approximate and for indicative purposes only. Subject to change. Not to scale. ^Lakeside Golf Club Camden is owned and operated by an unrelated third party. Stockland does not give any warranty or make any representation regarding the operations and/or continued use of the land as a golf course, including the Golf Course Maintenance Shed.

3 Stockland | Lakeside

The Fairway 4

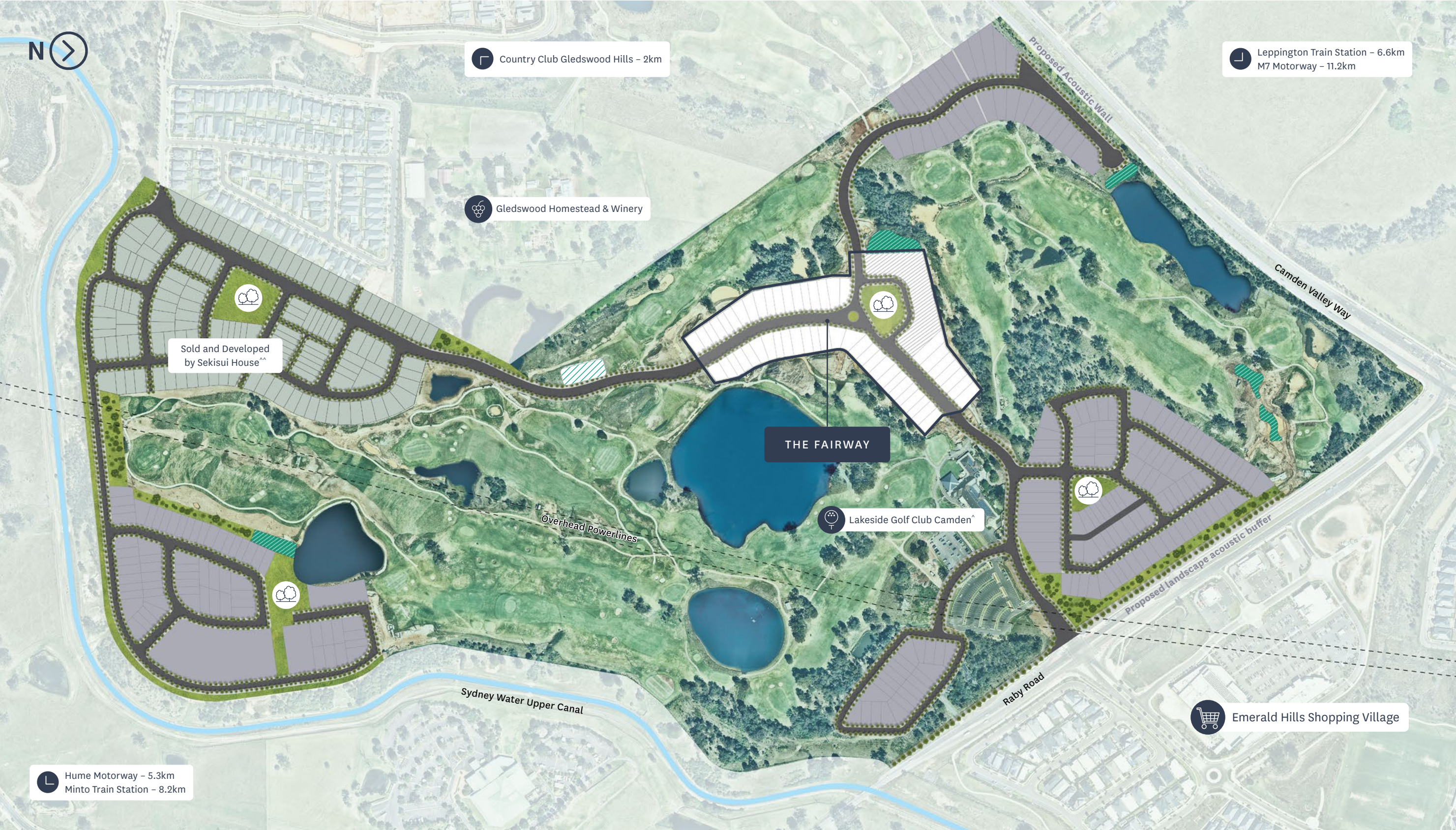

Masterplan

Legend

- The Fairway Lots
- Proposed Subdivision
- Sold and Developed by Sekisui House
- Proposed Display Village by Sekisui House
- Golf Course Maintenance Shed*
- Future/Proposed Bio-Retention Basin
- Proposed Local Park

Directions to the viewing point

Simply scan the QR code or search for: Stockland Lakeside Sales and Information Centre



Masterplan supplied for the purpose of providing an impression of Stockland Lakeside Gledswood Hills and the approximate location of existing and proposed third party infrastructure, facilities, amenities, services and destinations, and is not intended for any other purpose. Stockland does not make any representation or give any warranty in relation to the future development of the site, or the current or future amenity, location or existence of any facilities, services or destinations. All details, images and statements are based on the intention of, and information available to, Stockland as at the time of publication March 2023 and may change due to future circumstances. Any indications of location, distance or size are approximate and for indicative purposes only. Subject to change. Not to scale. All distances are estimates only, refer to distance or travel by car from 50 Raby Road, Gledswood Hills (unless specified otherwise) and are based on information obtained from Google Maps at the time of publication March 2023. This document is not legally binding on Stockland. Stockland does not give any warranty in relation to any information contained in this document. Stockland does not accept any liability for loss or damage arising as a result of any reliance on this document or its contents. *Layout subject to change. Subject to approvals. ^Lakeside Golf Club Camden is owned and operated by an unrelated third party. Stockland does not give any warranty or make any representation regarding the operations and/or continued use of the land as a golf course, including the Golf Course Maintenance Shed. ^^All lots in this stage have been developed and sold by Sekisui House. Stockland does not make any representation or give any warranty in relation to Sekisui House and/or its products or developments.

Are you ready for your life, curated at Lakeside?

Sales & Information Centre:

Fairbank Drive, Gledswood Hills NSW

Contact us:

lakeside@stockland.com.au

13 52 63

Follow us for community updates:

facebook.com/StocklandLakeside

For more information online:

Simply scan the QR code or visit:

stockland.com.au/lakeside



Stockland



Lakeside

All plans, diagrams, photographs, illustrations, statements and information in this brochure, including without limitation the location and size of any lots, are for illustrative purposes only and are based on information available to and the intention of Stockland at the time of creation (March 2023) and are subject to change without notice. No diagram, photograph, illustration, statement or information amounts to a legally binding obligation on or warranty by Stockland and Stockland accepts no liability for any loss or damage suffered by any person who relies on them either wholly or in part. Masterplan supplied for the purpose of providing an impression of Stockland Lakeside and the approximate location of existing and proposed third party infrastructure, facilities, amenities, services and destinations, and is not intended to be used for any other purpose. Indications of location, distance or size are approximate and for indicative purposes only. Subject to change. Not to scale. Lakeside Golf Club Camden is owned and operated by an unrelated third party. Stockland does not give any warranty or make any representation regarding the operations and/or continued use of the land as a golf course.