

FOR LEASE



FROM
\$36,099pa*

From 269.2 to 363.3m²

23 Packer Road, Bells Creek AURA BUSINESS PARK

Key Features

- Building expected to be completed mid-2019
- Total area 898.9 m²
- Tenancy 1: 362.3m² (includes mezzanine office)
- Tenancy 2: 267.4m²
- Tenancy 3: 269.2m²

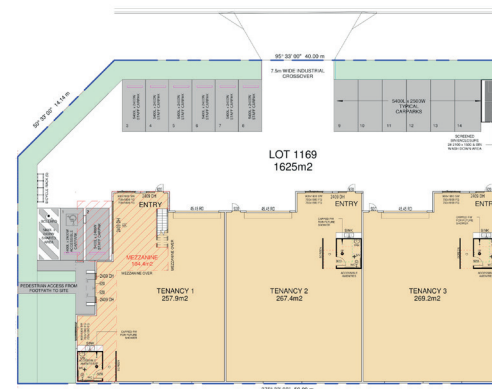

*Price does not include GST or outgoings. Pricing is correct as at date of publication and is subject to change without notice or obligation.



Ray White.

Colliers International
Ben Flower
E: ben.flower@colliers.com
M: 0488 773 033

Ray White
Jordan Hayes
E: jordan.hayes@raywhite.com
M: 0488 981 076

