

*Stockland is committed to sustainability and is Australia's leading developer of Green Star communities, as recognised by the Green Building Council of Australia.*

### *What to expect from a Stockland 5 Star Green Star community*

The 5 Star Green Star Communities rating recognises Australian leading design excellence across a wide range of environmental, economic and social sustainability measures. A 5 Star Green star-rated community is developed to Australia's highest environmental and liveability standards.

### *The Green Star five impact categories*

*The Grove has been designed, developed and evaluated against the Green Star rating system, providing a rigorous and holistic rating across these five impact categories.*



#### GOVERNANCE

**Demonstrates:**

- Leadership in engagement, transparency and community and industry capacity building.
- Resilience to a changing climate.



#### LIVEABILITY

**Development:**

- Of a safe, accessible and culturally rich community.
- Of healthy and active lifestyles.
- Of a high level of amenity, activity, and inclusiveness.



#### ECONOMIC PROSPERITY

**Encourages:**

- Projects that promote prosperity and productivity.
- Affordable living and housing.
- Investment in education and skills development.
- Community capacity building.
- Greater productivity through emerging opportunities in the digital economy.



#### ENVIRONMENT

**Reduces:**

- The impact of urban development on ecosystems.
- Ecological footprints.
- Impact on land, water and the atmosphere.

**Encourages:**

- Resource management and efficiency by promoting infrastructure, transport and buildings with reduced ecological footprints.



#### INNOVATION

**Recognises:**

- The implementation of innovative practices, processes and strategies that promote sustainability in the built environment.





*Stockland is committed to building healthy, smart and connected communities.  
The Grove has achieved a 5 Star Green Star communities rating,  
which recognises Australian Excellence.*



#### HEALTHY COMMUNITIES

Providing people friendly spaces and amenities for an active lifestyle, our communities encourage walking, cycling and active recreation.



#### SMART COMMUNITIES

From the very start, a Stockland smart community is designed to help preserve the environment.

When we build our communities, we divert as much rubbish as we can away from landfill, and where possible use recycled or recyclable materials.

We carefully consider the protection and preservation of native flora and fauna, and the recycling of water to meet demands of open space.

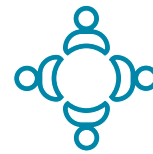

#### CONNECTED COMMUNITIES

Stockland communities are connected communities. Designed to give you space and opportunity to interact with family, friends, neighbours or just to enjoy your own time.

We provide close proximity to amenities like sporting facilities, walking and cycling paths, parks and open spaces. It's important to us to offer the opportunity for residents to participate in a wide variety of activities to keep your interests alive and well, to learn new things and spend time with friends.



## The Grove – 5 Star Green Star communities rating.



### HEALTHY COMMUNITIES

- An upgrade of the leisure areas surrounding Davis Creek will make it a destination for families in the region, with plans for a shared path, exercise stations, viewing platforms and wetlands.
- Abundance of open space including a future sporting oval and neighborhood parks. The Link & Learn program by Stockland encourages residents to connect with each other and gain new skills through fun and creative events. 'Live Life Get Active' launches February 2017.
- Proposed community garden for neighbourly interaction and production of herbs, fruits and vegetables.



### SMART COMMUNITIES

- Protection and enhancement of the habitat of growling grass frogs, which are indigenous to the area.
- Construction of two tunnels that allow growling grass frogs to cross beneath a busy road intersection.
- Dedicated integrated sustainability education trail along Davis Creek with both cycling and walking paths.

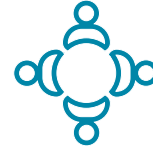

### CONNECTED COMMUNITIES

- Proximity to new Tarneit Train Station, which provides a direct 31 kilometre commute to the Melbourne CBD.
- Masterplan creates a highly walkable community, with homes connecting to pedestrian walkways, parks, playgrounds and public open spaces.
- Touched by Olivia designed inclusive playground for all ages and abilities.
- Convenient access to the planned town centre, with a supermarket and a range of specialty stores.
- A primary and secondary school are planned for the community, along with a community centre, sports field and a potential retirement village.

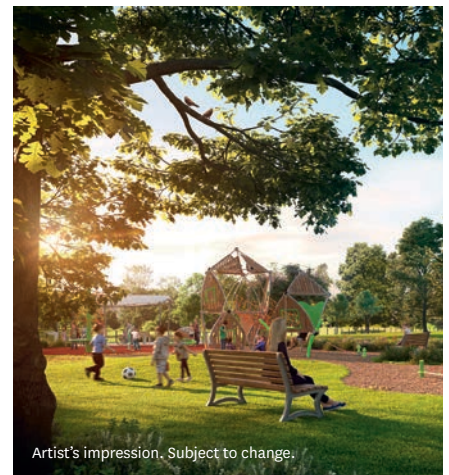

All images and statements are based on information available to Stockland at the time of publication (November 2016) and may be subject to change without notice. The Grove's 5 Star Green Star Rating is based on the current masterplan design for The Grove and is subject to review after 5 years.

